



1

## SPECIFICATION

Stainless Steel AISI 304 NI

matte MT



2

## FEATURES AND APPLICATIONS

Tolerances of chamfers, different sheet metal thicknesses or the use of seals could mean that the mounting surfaces of multiple-joint hinges on the frame and door do not have the desired separating distance.

Plates for jointed hinges GN 7247.2 are designed with appropriate dimensions as accessories for jointed hinges GN 7241 (see page -), GN 7243 (see page -) and the GN 7247 (see page -). They allow for adjustment in the third plane during mounting. Shimmed individually or in combination, they provide the desired position or height compensation on the fastening surfaces.

The holes  $d_2$  receive tensioning or positioning pins, if necessary, making it easy to position the plates and the multiple-joint hinges.



3



4



5



6



7

## ON REQUEST

other plate thicknesses



8



9



10



11



12



13



14



15



16



17



18



19



20



21



22



23



24



25



26



27



28



29



30

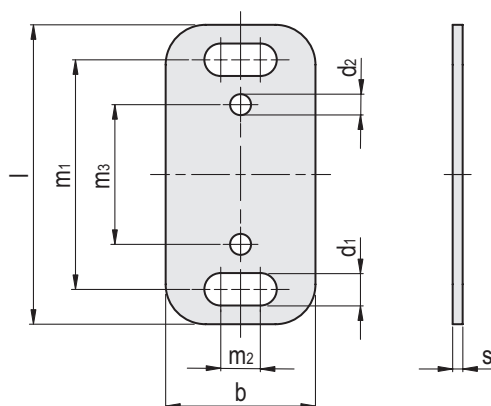
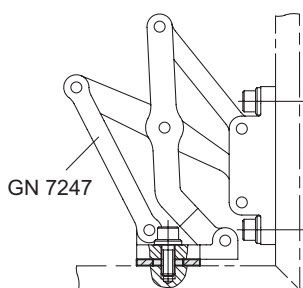

## Conversion Table

1 mm = 0.039 inch

mm	inch
60	2.34

INOX  
STAINLESS  
STEEL

METRIC

Code	Description	l	d1	d2	b	m1	m2	m3	s	⚖️
GN.72441	GN 7247.2-NI-60-0.5-MT	60	6.5	4.2	30	46	8	28	0.5	6
GN.72442	GN 7247.2-NI-60-1-MT	60	6.5	4.2	30	46	8	28	1	12
GN.72443	GN 7247.2-NI-60-2-MT	60	6.5	4.2	30	46	8	28	2	24